

CITERNE SOUPLE EFFLUENTS

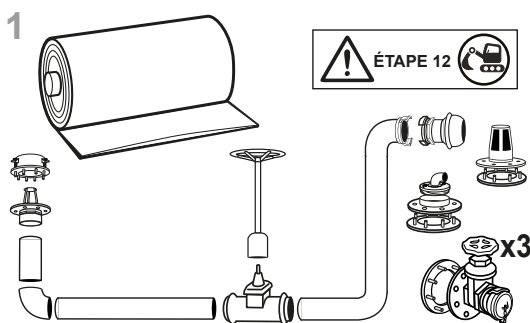

ATTENTION
Si le remplissage ne se fait pas dans l'immédiat :
lester la citerne avec 5 cm de liquide minimum

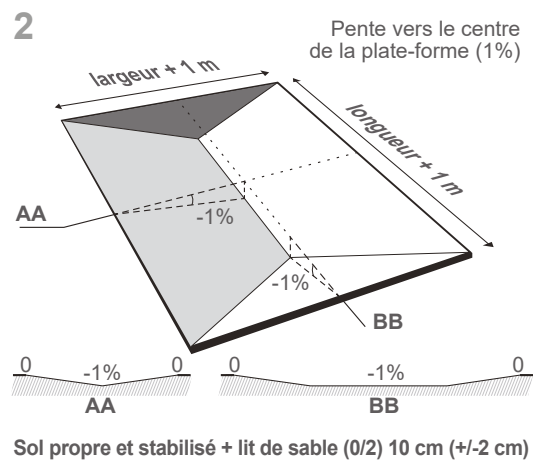

3 IMPORTANT
Installation de la citerne suivant son volume

V. (m ³)	nombre de personnes
de 1 à 180	1 à 2
de 180 à 480	3 à 4
de 480 à 800	4 à 6
de 800 à 1200	6 à 8
> 1200	8 à 10

Il est **formellement interdit** de manipuler le produit à l'aide d'engins pour éviter toute détérioration

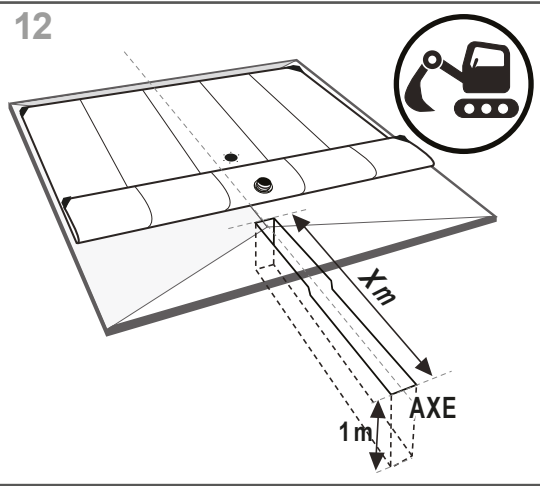
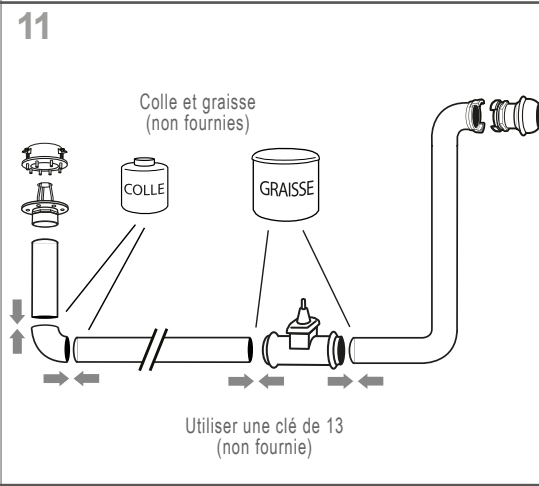
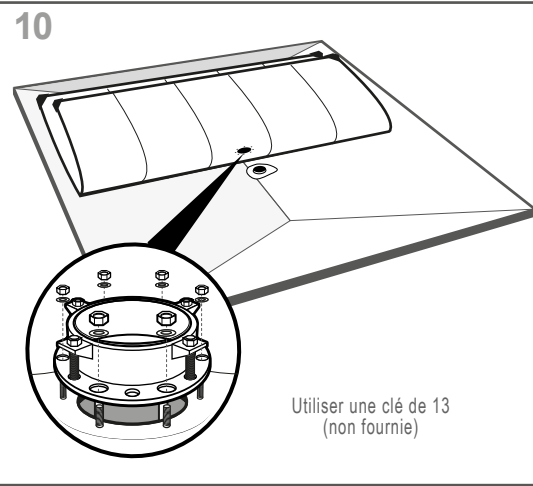
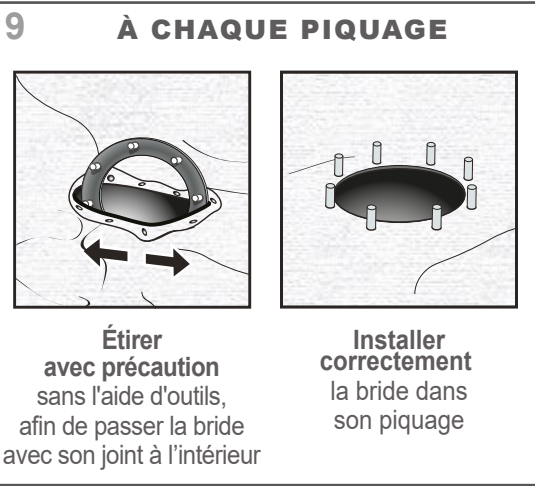
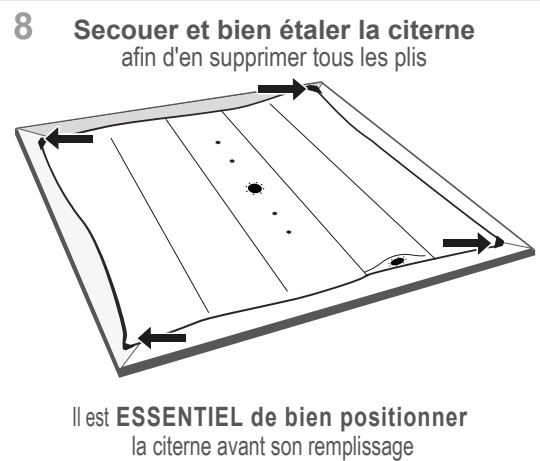
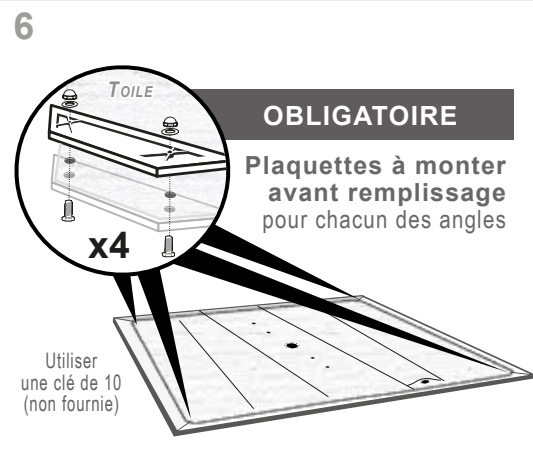
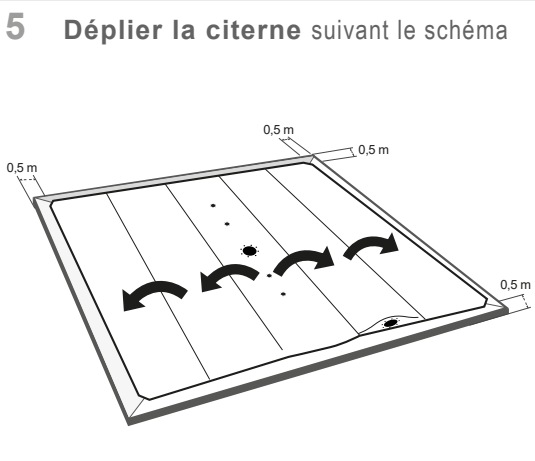
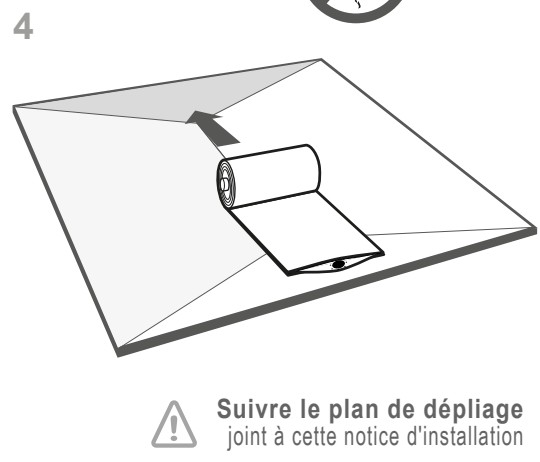

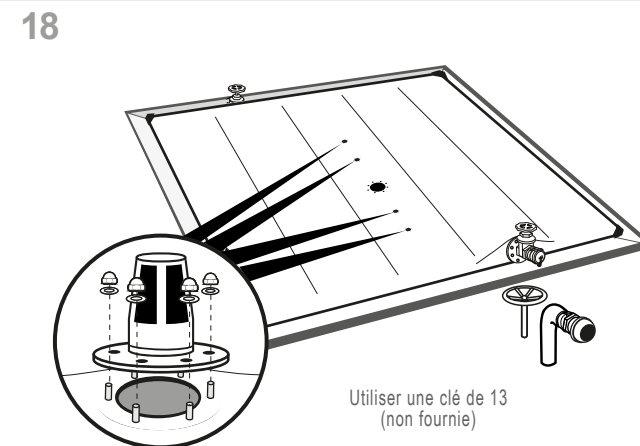
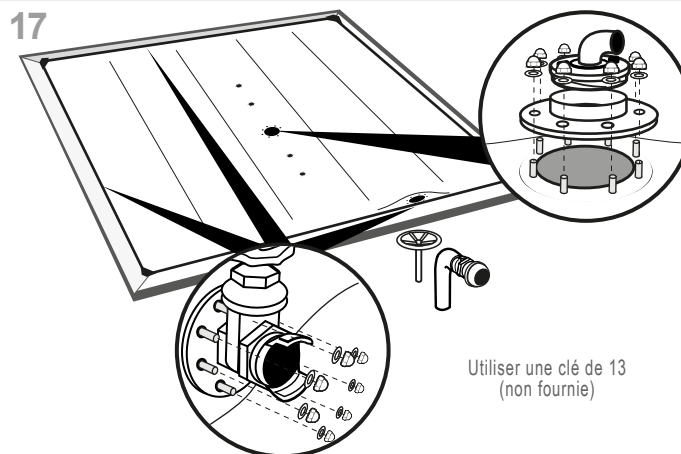
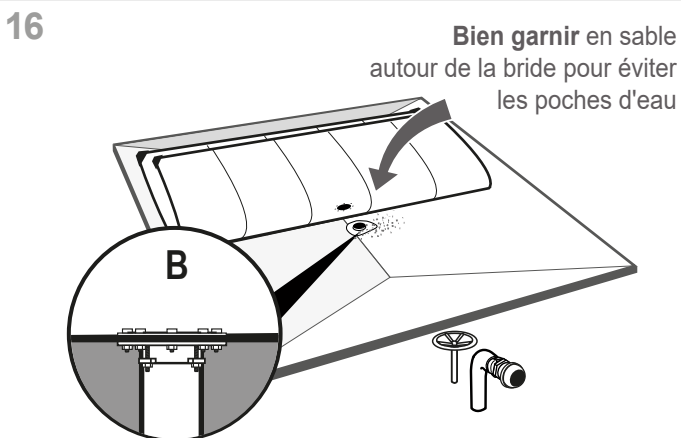
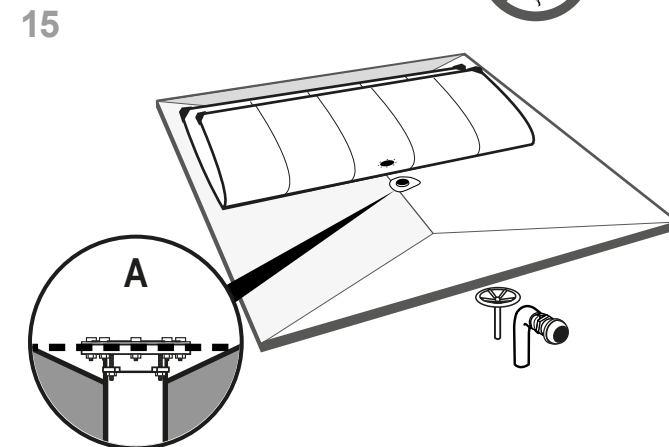
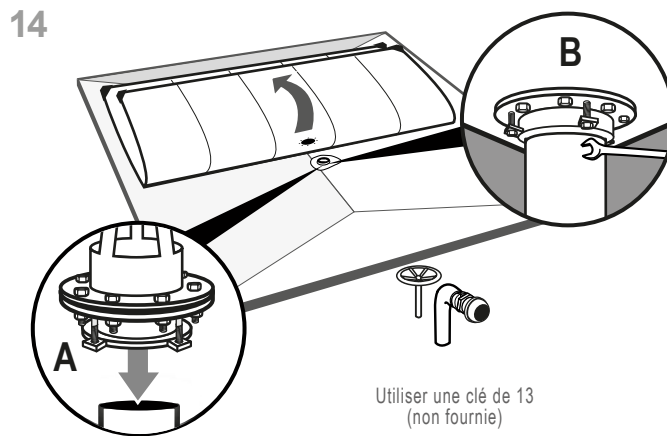
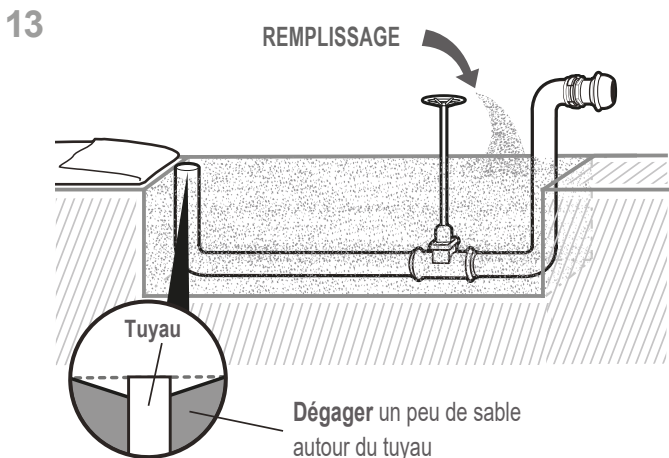

19

ÉTAPES ESSENTIELLES À RENOUELER

1 Brasser la citerne par les angles de haut en bas manuellement

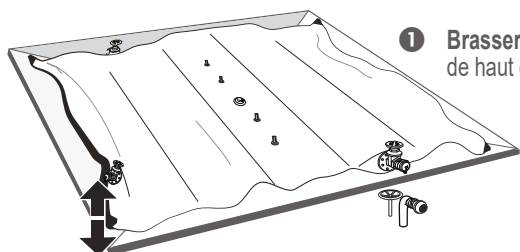

2 Secouer et étaler la citerne : il ne faut aucun pli à sa surface pour procéder au remplissage

